

**LP-810/W Low-intensity Type B Double Solar Aviation Obstruction Light**



**Application**

LP-810/W Low-intensity Type A Double Solar-Powered Aviation Obstruction Light can be provided with power supply without power transmission cables by solar power, so it is suitable for those locations, Electric Tower, High-rise Building, High Chimney, marking towers (Telecom, GSM, Microwave & TV), High Pole, Tower Crane, Wind Turbine and other potentially hazardous obstructions within 45 meters to air traffic with a steady burning red safety light, especially which are hard to lay the cable or lack of power supply as well as those facilities which have high requirements on lightning protection.

## **Advantage**

- International advanced solar panel reaching at least 10 years service life.
- Comprehensive protection in voltage short, over-voltage, floating Charge and temperature.
- Built-in Solar Panel.
- Strong corrosion resistance, Rain and Snow, Shock and Vibrations protection and UV protection.
- International-advanced cold LED with low power consumption, high brightness and service life of light source reaching 100000hours.
- Clean, renewable, green and reliable energy source
- Dusk-to-dawn operation: New technology application.Light can work at night automatically by solar panel which function is equal to photocell sensor.
- At least 7 days autonomy.
- Recyclable 3 to 5years Lithium iron phosphate battery(LiFePO<sub>4</sub>) with the lightest environmental.
- Small volume especially being suitable for Telecommunication Tower and Electric installation way.
- Main(Service)-standby way.As usual,Main(Service) light works,standby light does not operate;Once Main(Service) light fails,standby light will work automatically.

**Main Parameter**

<b>Name</b>	<b>Data</b>
Model	LP-810/W
Standard	ICAO (Aerodromes Annex 14) Low-intensity Type A and FAA L-810
Light intensity	≥10cd
Flash rate	Steady-burning mode or Flashing mode (20-60times/minute)
Light source	LED,≥100,000hours
Operating voltage	DC12V(Solar powered Way)
Battery	-Lithium iron phosphate battery(LiFePO <sub>4</sub> ) -Capacity:12V,12Ah -Battery Replace:Yes
Power Source(Solar Module)	-Mono-crystalline silicon --Solar Efficiency:19%
Power consumption	≤4W
Overall size(mm)	137 by 120 by 208
Installation size(mm)	3/4inch
Vertical degree	≥10°
Horizontal degree	360°
Material	-Housing: PC -Base: die casting aluminum
Weight	5.3Kg
Emitting color	Red
Ambient temperature	-40℃~+60℃
Wind load	80m/s

Protection standard	IP65
---------------------	------

**Dimension Drawing**

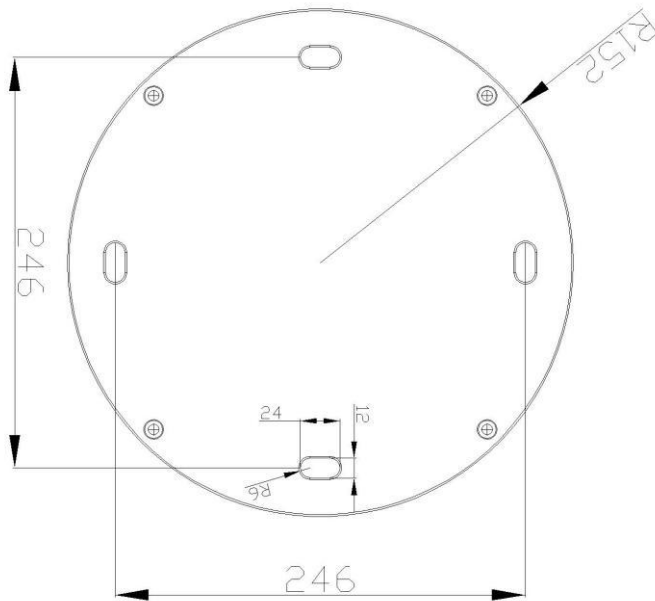
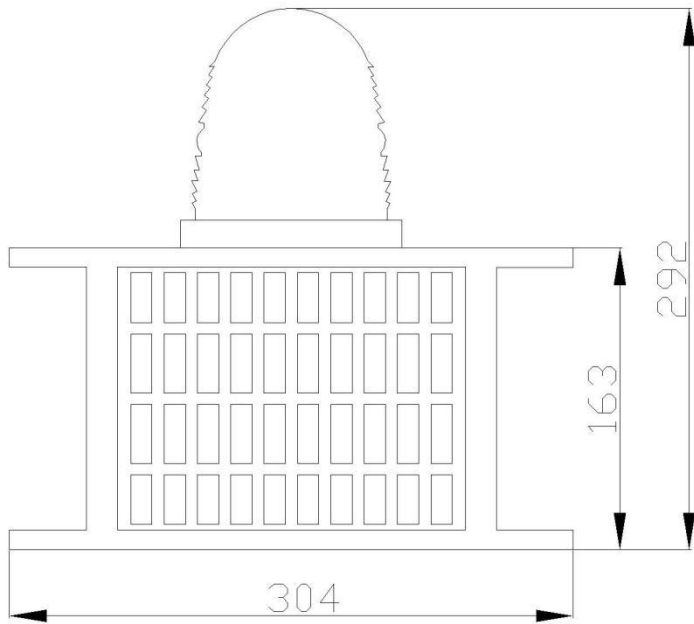

Unit:mm

**Cases**

